

FLOOR CONSTRUCTIONS

Low Profile Floating Floor

Overview

The Low Profile Floating Floor system utilises 12mm MLCP (spaced at 150mm centres) laid into 15mm thick pre-routed polystyrene panels. The boards are covered in an aluminium foil which acts as the heat emitter, effectively spreading the heat evenly across the entire floor.

Although the polystyrene panels will offer some insulation, it's likely that additional insulation will be required in ground floors to comply with Part L of the Building Regulations.

A floating floor is to be laid over the panels and the floor must have sufficient strength to support furniture and traffic in the room.

Features and Benefits

- **Low Profile Heating System** – Only 15mm high, minimal increase to floor height.
- **Dry Alternative to Wet Screed Systems** - Reduces the time on site, benefitting the build programme.
- **Space Saving** - Where maximum room area is at a premium.
- **Unobtrusive** - Minimum disruption when installing in existing buildings.
- **Comfort Underfoot** - Use to achieve a 'sprung floor finish'.

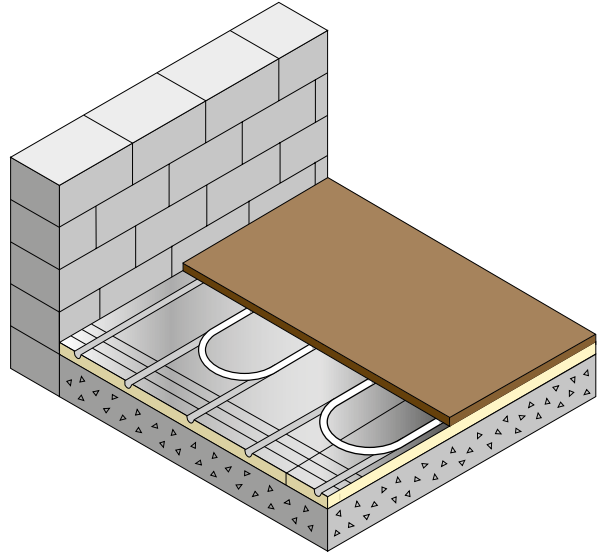

Key Components

Maincor MLCP, PE-RT/AL/PE-RT Coils



Maincor MLCP, PE-RT/AL/PE-RT, overlap welded aluminium Multi-Layer 100% barrier composite pipe. Available in 12mm (80 or 240m coils).

Floating Floor – Low Profile 15mm



EPS200 polystyrene foam with Aluminium foil, 45microns thick, is factory bonded to the upper surface of the panel (and into the main grooves). The boards are 15mm thick and are pre-routed to accept 12mm pipe laid at 150mm centres. (Special order only, please call for availability).



FLOOR CONSTRUCTIONS

Low Profile Floating Floor

Technical Details

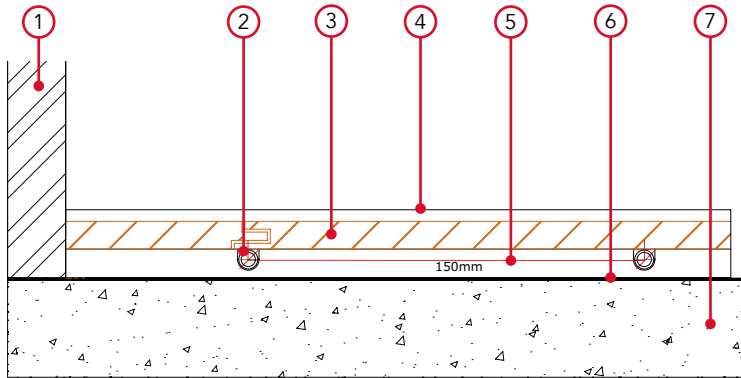

Key:

1. Wall
2. 12mm MLC Pipe
3. Structural Floor
4. Floor Covering
5. 15mm Low Profile Floating Floor Panel
6. DPM
7. Structural Slab

Maincor Low Profile Floating Floor Panels are manufactured from polystyrene foam, CNC machined into the upper surface of the panel. Aluminium foil, 45microns thick, is factory bonded to the upper surface of the panel (and into the main grooves) and acts as a radiant surface improving heat transfer and reducing system start up (response) times.

The grooves in the insulation securely retain the continuous UFH pipework in the correct position, eliminating the need for supplementary fixings. Additional pipe channels can be routed from the insulation using a knife. The system should be fully pressure tested prior to the structural floor being laid. The boards are 15mm thick and are pre-routed to accept 12mm pipe laid at 150mm centres.

Installation Overview

When installing underfloor heating systems ensure that all relevant health and safety legislation and local site regulations are fully adhered to at all times.

Before starting to install the underfloor heating system, the working area should be prepared:

- The area must be weather tight. Ensure that the boards, manifolds and electrical components, etc are sufficiently protected from wet weather.
- Site specific PPE is required.
- The floor is to be solid, level, clean and free of debris.
- A self levelling compound can be used to prepare the floor where it is uneven.
- Screw down any uneven floorboards or replace as required.
- Take time to plan your installation prior to laying to minimise the need to cut boards.



1. Ensure floor is level.



2. Boards in place.



3. Roll-out the 12mm pipe into the required pattern and fit into the grooves.